



146 PRINCESS DRIVE, SEAFORD, EAST SUSSEX, BN25 2TS

£425,000

This charming three bedroom detached bungalow is located on Princess Drive in Seaford. Conveniently situated near local convenience store, bus route, schools, walks and golf course.

Seaford and Bishopstone railway stations are both situated within 1.5 miles having services to London and Brighton.

The bungalow offers good size accommodation with all the rooms coming from a large L-shaped hallway, including lounge/diner, kitchen/breakfast room, three bedrooms, a bathroom and separate cloakroom.

Other features and benefits include a detached single garage with electric roller door, gas fired central heating and south easterly aspect rear garden.

An internal inspection is advised to appreciate the accommodation on offer.

- THREE BEDROOMS
- DETACHED BUNGALOW
- WELL PRESENTED
- LOUNGE/DINER
- KITCHEN/BREAKFAST ROOM
- GENEROUS SIZED SOUTH EASTERLY ASPECT REAR GARDEN
- SITUATED IN A POPULAR LOCATION
- CLOSE TO LOCAL SHOP, BUS ROUTES AND WALKS
- SINGLE GARAGE WITH ELECTRIC ROLLER DOOR
- OFF ROAD PARKING FOR TWO VEHICLES



GROUND FLOOR
97.9 sq.m. (1054 sq.ft.) approx.

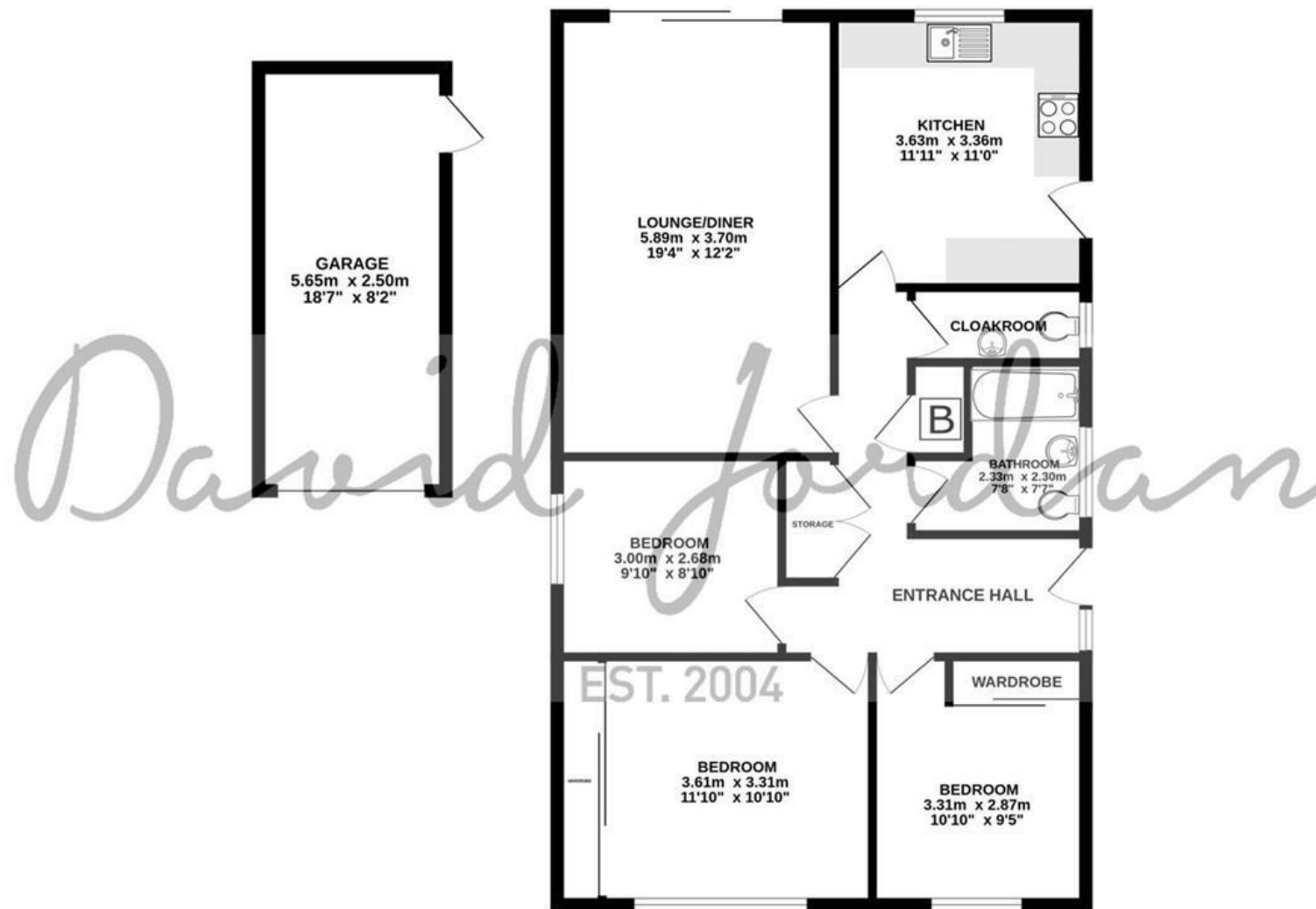

146 PRINCESS DRIVE SEAFORD

TOTAL FLOOR AREA : 97.9 sq.m. (1054 sq.ft.) approx.

Whilst every attempt has been made to ensure the accuracy of the floorplan contained here, measurements of doors, windows, rooms and any other items are approximate and no responsibility is taken for any error, omission or mis-statement. This plan is for illustrative purposes only and should be used as such by any prospective purchaser. The services, systems and appliances shown have not been tested and no guarantee as to their operability or efficiency can be given.
Made with Metropix ©2025



COUNCIL TAX BAND

Local Authority: Lewes District Council

Council Tax Band: D

ENERGY PERFORMANCE CERTIFICATES (EPC)

Energy Efficiency Rating: E

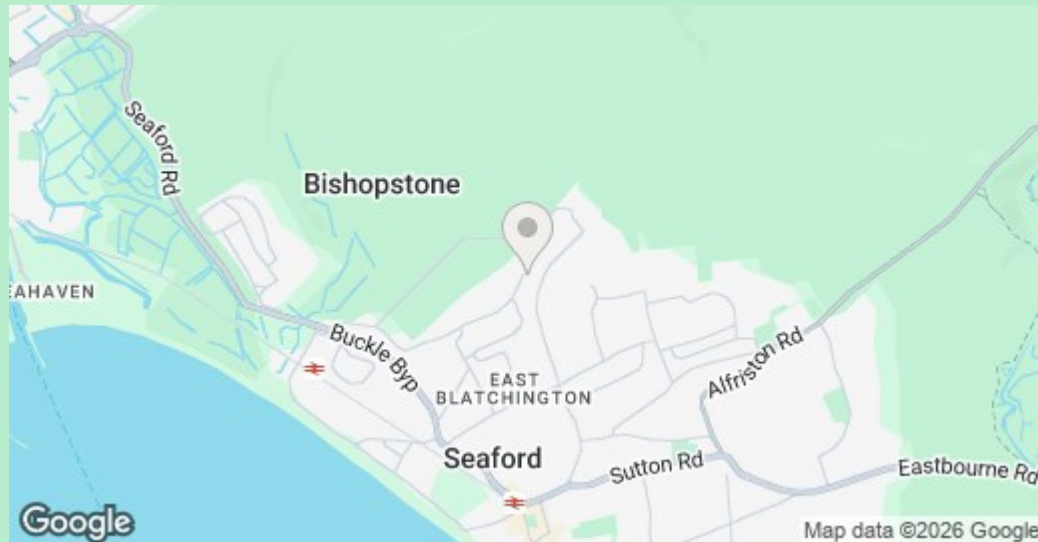

DISCLAIMER

Money Laundering Regulations 2017: Intending purchasers will be asked to produce identification documentation upon acceptance of any offer. We would ask for your cooperation in producing such in order that there will not be a delay in agreeing the sale.

General: Whilst we endeavour to make our sales particulars fair, accurate and reliable they are only a general guide to the property and accordingly if there is any point which is of particular importance to you please contact the office and we will be pleased to check the position for you. Buyers must check the availability of any property and make an appointment to view, before embarking on any journey to see a property. Items shown in photographs are NOT included unless specifically mentioned within the sales particulars. They may however be available by separate negotiation.

Measurements: These approximate room sizes are only intended as general guidance. You must verify the dimensions carefully before ordering carpets or any built in furniture.

Services: Please note we have not tested any apparatus, equipment, fixtures and fittings or services and so cannot verify that they are in working order or fit for the purpose. A Buyer is advised to obtain verification from their Solicitor or Surveyor. References to the Tenure of a Property are based on information supplied by the Seller. The Agent has not had sight of the title documents. A Buyer is advised to obtain verification from their Solicitor. These particulars are issued in good faith but do not constitute representations of fact or form part of any offer or contract.

01323 898414

sales@davidjordan.co.uk

davidjordan.co.uk

David Jordan

EST. 2004